

Keyless 200

User Manual



Industrilas
— When access counts —

In the Package

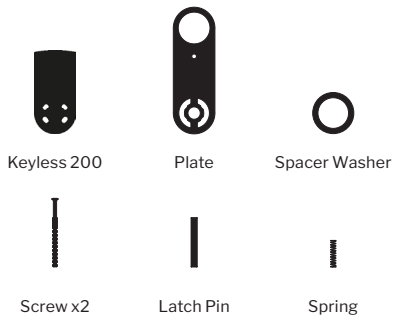

Content

1. Installation of Keyless 200
2. Connection, administrator code and user code
3. Adding or replacing a user code
4. Unlocking and locking
5. Deleting a user code
6. Selecting locking method
7. Changing code length
8. When the batteries run out
9. Automatic blocking
10. Factory reset

Read This Before You Start

- The lock is delivered without any pre-programmed codes.
- During the initial setup, you must programme an administrator code and a user code.
- When you have programmed the administrator code and entered the main menu, each correct selection is confirmed by the green and red lights flashing rapidly twice.
- You always have 30 seconds to make your next selection during programming. If no selection is made within this time, the lock returns to the main menu or locks (if you are already in the main menu).
- If you press the wrong button, the red light will flash and the lock will return to the main menu.
- When in a submenu, you can always press the lock button to return to the main menu.
- Pressing the lock button while in the main menu exits administrator mode. This is indicated by both the green and red lights shining steadily.
- Always use high-quality batteries.



Product details and how-to videos at
industrilas.com

1. Installation of Keyless 200

- 1.** Remove the existing handle set.

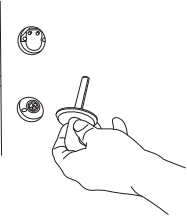

- 3.** Insert the spring into the inner handle.

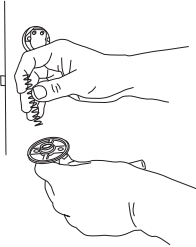

- 2.** Replace the latch pin with the one supplied.

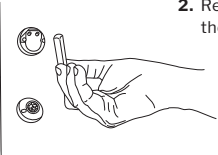

- 4.** Insert 2 high-quality AAA batteries.

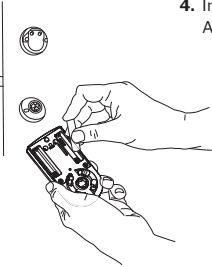

- 5.** Place the plate and Keyless 200 on the inside of the outer handle.

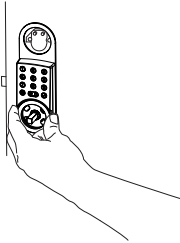

- 6.** Secure all parts with screws. Some handles have a raised handle hub. In these cases, place the spacer washer between the handle and the lock (A).

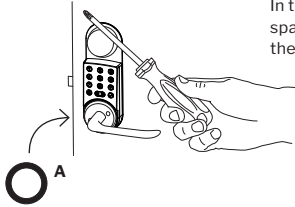

2. Setup, Administrator Code and User Code

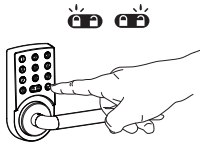

- 1.** Wake up the lock for the first time by pressing the lock button. The red and green lights will flash alternately for a few seconds, indicating that no codes are programmed.
- 2.** When the flashing stops, enter a 6-digit code.
- 3.** Verify the code by entering it again.
- 4.** Enter a 4-digit user code. This will automatically be stored in position 1 (if you prefer 5- or 6-digit user codes, see point 7 below).
- 5.** Verify the code by entering it again.
- 6.** Both the administrator code and the first user code are now programmed.
- 7.** To change the administrator code, enter the main menu, press button 9, then enter the new code twice. To add or change user codes, see section 3.

3. Adding or Replacing a User Code



- 1. Hold button 9 for 5 seconds.
- 2. When the green light flashes, enter the administrator code.

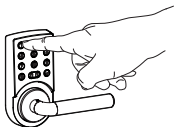

- 3. Press button 1 to add or replace a user code.
- 4. Select the position where the code will be stored (1–9).
- 5. Enter a 4-digit code (the green light starts flashing).

4. Unlocking and Locking

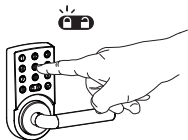

- 6. Verify the code by entering it again (the green light shines steadily).
- 7. Press the lock button or wait 30 seconds to exit programming mode.

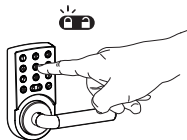

To unlock: Enter your user code (the green light turns on).

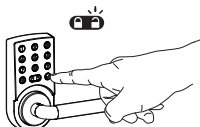

To lock: Press the lock button (the red light will illuminate briefly after the lock has been secured). If you wish to change the locking method, see **Selecting Locking Method**.

5. Deleting a User Code



- 1. Hold button 9 for 5 seconds.
- 2. When the green light flashes, enter the administrator code.

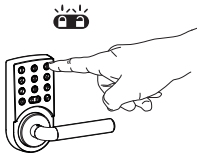

- 3. Press button 3.
- 4. Enter the position number of the code you want to delete (1–9). Press 0 to delete all user codes.
- 5. The green and red lights will flash twice simultaneously to confirm the selection.
- 6. Enter the position number again to confirm deletion.
- 7. Press the lock button or wait 30 seconds to exit programming mode.

6. Selecting Locking Method

There are three locking options:

- 1. Lock using the lock button: Press the lock button to lock.
- 2. Lock using user code: Enter a valid user code to lock.
- 3. Automatic locking: The lock will automatically engage 10 seconds after unlocking.



To select a locking function:

- 1. Hold button 9 for 5 seconds.
- 2. When the green light flashes, enter the administrator code.
- 3. For lock function 1, enter 711.
For lock function 2, enter 712.
For lock function 3, enter 713.
- 4. Press the lock button or wait 30 seconds to exit programming mode.

7. Changing User Code Length

You can choose between three code lengths: 4, 5 or 6 digits (the administrator code is always 6 digits). All lock codes must be the same length. Changing the code length will delete all previously stored codes, and new ones must be entered.



To change the code length:

- 1. Hold button 9 for 5 seconds.
- 2. When the green light flashes, enter the administrator code.
- 3. For 4-digit codes, enter 724.
For 5-digit codes, enter 725.
For 6-digit codes, enter 726.
- 4. Press the lock button or wait 30 seconds to exit programming mode.

8. When the Batteries Run Out

- With normal use, high-quality batteries last approximately 2–3 years.
- Replace the batteries (2 x AAA) when the red light starts flashing while entering your code.
- All codes remain stored after battery replacement.
- Do not mix old and new batteries.
- Dispose of used batteries according to environmental regulations.
- To replace the batteries, the lock must be disassembled.

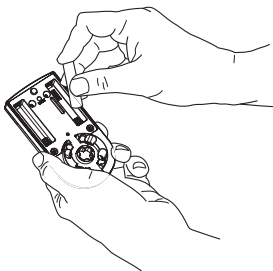

9. Automatic Blocking

If an incorrect user code is entered four times in a row, the lock will be blocked. This is indicated by the red light flashing slowly. To exit blocking mode, a correct user code must be entered twice.

10. Factory Reset

To perform a factory reset, the lock must be disassembled. Then press the unlock button and hold the RESET button for 3 seconds. When the reset is complete, the red and green lights will flash for 5 seconds.

A factory reset erases the administrator code and all user codes. The locking function is restored to default, meaning the lock button locks the unit and codes are set to six digits in length.

Once the flashing stops, a new administrator code must be programmed before the lock can be used again.