



## VISION LIFT HANDLE

The patented Vision Lift Handle operates all Vision™ latching systems. The handle is available with a push button, a tool operated insert, a round cylinder keyed to differ or keyed alike or prepared for a 40 mm profile cylinder or oval cylinder.

The handle is spring loaded and pops out when it is unlocked or the push button is pressed. Since the locking mechanism is not a part of the actual handle, it is very comfortable to operate.

Cylinders and inserts are covered by a sliding dust cover. IP65 waterproof according to NEMA 4.

### MATERIAL

**Dish:** Glass fibre reinforced polyamide (PA6GF30)

**Handle:** Zinc die cast, black powder coated

**Insert:** Zinc die cast, chrome plated

**Pivot shaft:** Zinc die cast, zinc plated

### RELATED PRODUCTS

**Rod latch systems:** 1-008.04, 1-008.05, 1-008.21, 1-008.25, 1-008.07

**Cylinders:** 1-209, 1-210, 1-211, 1-010

Use the Index Code at [industrilas.com](http://industrilas.com)

### TECHNICAL INFORMATION

The lift handle fits into a cut out similar to Version C, but with an additional  $\varnothing 4,5$  mm hole on top. Suitable for door thickness 0,8-3,5 mm. When viewed from the outside, the right hinged version has a pivot shaft that rotates counter-clockwise when opening. The left hinged version rotates clock-wise when handle is opened.

**Standards:** IP65, NEMA 4

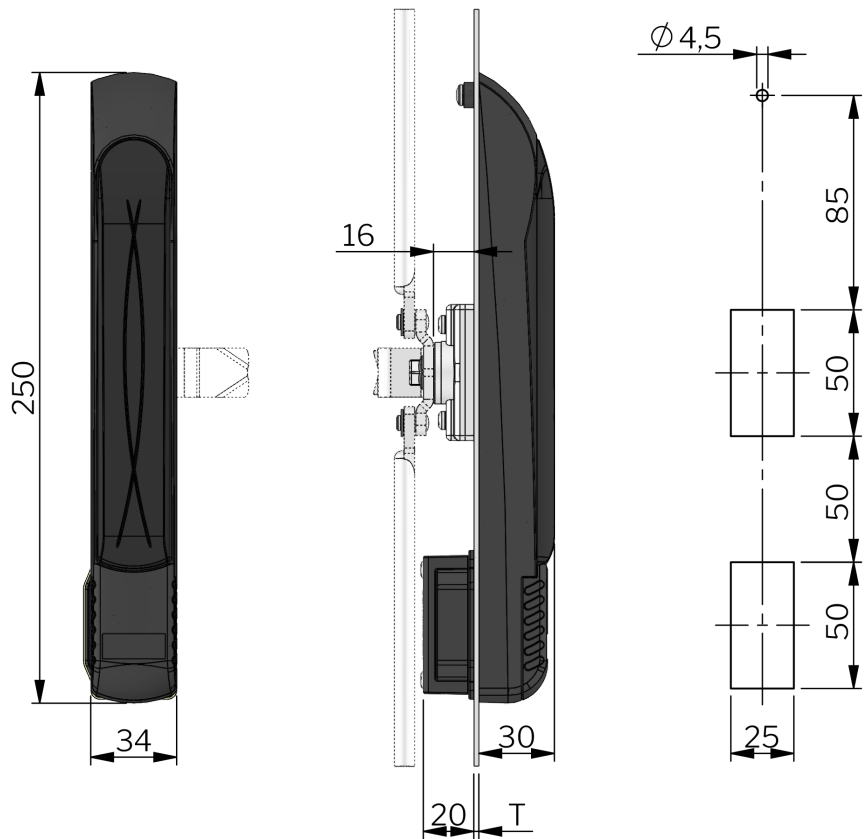

**Make your selections in each column to create your article number (AAAA-BBCDEF-GG)**

AAAA Type		BB Insert / Cylinder		C Surface treatment insert	D Protection degree	E Surface treatment handle	F Model	GG
1510	Flat rod system	01	Square 6	0 For cylinder and push-button versions	5 IP65		0 For right hinged door	00
1511	Cam and round rod system	03	Square 7			6 Black powder coated		
		05	Square 8	2 Chrome plated		9 Silver powder coated	1 For left hinged door	
		07	Square 8 / slotted	6 Black powder coated				
		11	Square 8 / Recessed					
		14	Triangle 7					
		15	Triangle 8					
		16	Triangle 10					
		22	Double Bit 3					
		24	Double Bit 5					
		26	Slotted					
		29	Slotted, recessed					
		32	Hexagon 11					
		34	Recessed hexagon 8					
		35	Recessed hexagon 10					
		36	Recessed hex 8/3mm pin					
		80	Keyed to differ					
		81	Keyed alike IL101					
		82	Keyed alike IL0333					
		83	For profile cylinder					
		84	For Oval Cylinder					
		90	Push button					

