



## VISION OUTSIDE

Vision Outside – 行业领先的专利锁具系统，适用于对质量要求较高的应用，特别为需要完全隔绝天气情况影响的机柜而研发。该系统内置有一个 3 毫米压缩功能，同时注重细节和专业工艺（从金属铸造到粉末涂层），将 Vision Outside 打造成了市面上最精密的锁具系统。如果您需要在恶劣的环境中保护重要的电子设备，那么此系统将是您的理想选择。



### 材质

Control mechanism: 尼龙6+30%玻纤

Rod: 不锈钢304

### 相关产品

把手: 1-004.04, 1-002.02, 1-005.10, 1-006.50,  
1-002.01, 6-010, 1-002.03, 1-006.01, 1-006.03,  
1-007, 1-002.08

连杆: 1-008.05/13

Needed components for a complete system:

1-008.05

索引编号见网站 [industrilas.com](http://industrilas.com)

### TESTS & STANDARDS

- Multiple latching points for perfect latching and compression in tall applications.
- System with more than four latching points available upon request.
- Control mechanism comes complete assembled with flat rod. Latching points ordered separately.

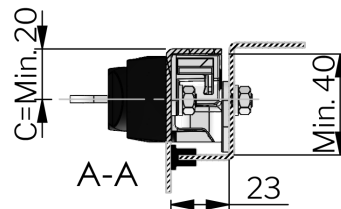
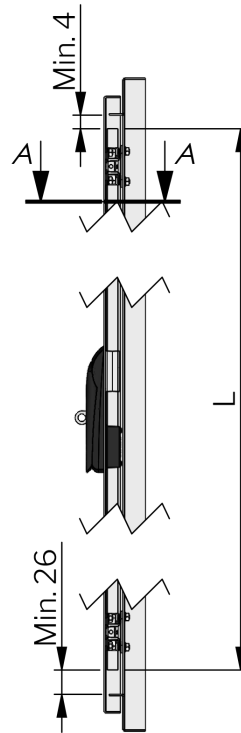

**Industrilas**  
— When access counts —

## 每一栏选择对应的数字创建产品编号 (AAAA-BBBB-CCCC)

AAAA	Material rod	Material control mechanism	BBBB	Rod system	CCCC	L in mm	L1 in mm	L2 in mm
1321	钢, 镀锌	Zinc, zinc plated	1000	Vision Inside + Vision Outside	0500	500	200	-
1390	不锈钢 316	Zinc, Delta seal			0900	700	300	-
1350	钢, 镀锌	PA6GF30			1200	1500	400	-
1395	不锈钢 316	PA6GF30			982	982	300	700
					1700	1700	300	800

