

# SLAM LATCH



Spring-loaded cam for manual operation that allows slam-latch action. The drawing shows: fixed (Y or Z) or turnable (X) cam. Stroke 7,8 - 12 mm. Screw or weld-on mounting.



## MATERIAL

**Cam:** Zinc die cast or steel, zinc plated

**Housing:** Steel, zinc plated or unplated

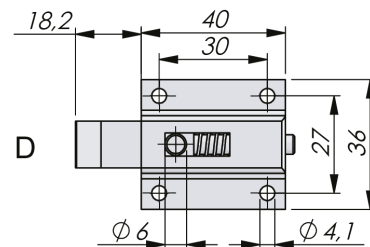
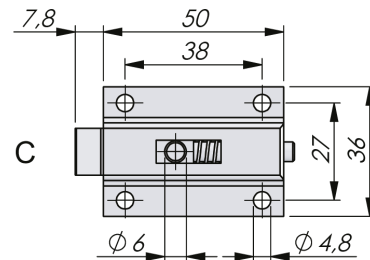
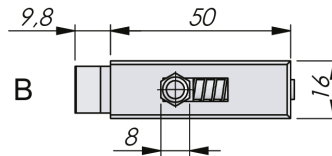
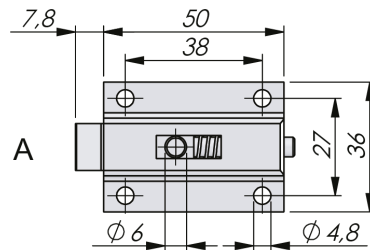

P/N	Cam	Stroke	Type	Mounting	Cam length	Drawing
522101	Zinc	7,8 mm	Z	Screw	7,8 mm	A
522102	Zinc	7,8 mm	Y	Screw	7,8 mm	A
522103	Zinc	9,8 mm	X	Weld-on	9,8 mm	B
522105	Steel	9,8 mm	X	Weld-on	9,8 mm	B
522106	Steel	7,8 mm	X	Screw	7,8 mm	C
522107	Zinc	12 mm	Z	Screw	18,2 mm	D
522108	Zinc	12 mm	Y	Screw	18,2 mm	D

Weld-on version supplied untreated.

