

CONTINUOUS HINGE STAINLESS STEEL



Continuous stainless steel hinge with recessed holes suitable for screw-on mounting. Supplied in custom lengths according to your choice. The length L is stated in millimeters and inserted in the last positions of the part number, instead of the -LLLL.

For instance, part number 3530-110720-0852 is 852 mm long. Minimum order quantities applies when ordering custom lengths.

Also available in standard length of 3 500 mm.



MATERIAL

Hinge: Stainless steel 304

RELATED PRODUCTS

Similar products: 6-560

Other materials: 3-820

Use the Index Code at industrilas.com

TECHNICAL INFORMATION

The J-measurement describes the largest diameter of the countersunk and not the diameter of the hole.

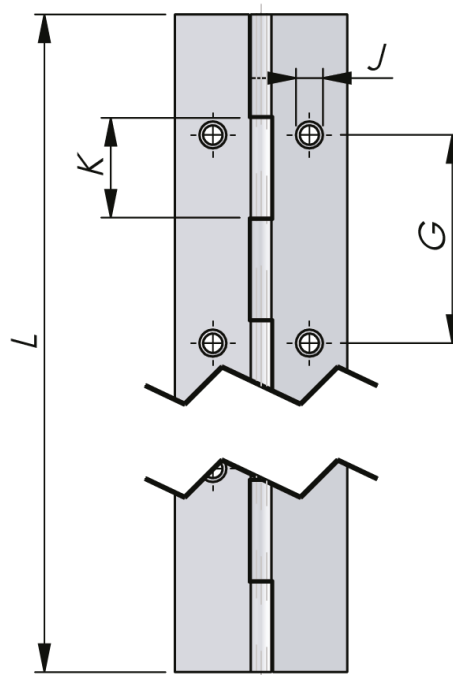
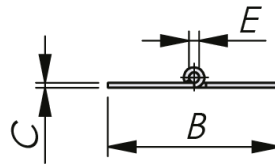

Continuous Hinge with Holes - for Screw-On Mounting

B=	J=	C=0,7 mm E=1,75 mm G=60,4 mm K=15 mm	C=1,0 mm E=1,75 mm G=60,5 mm K=15 mm	C=1,25 mm E=2,5 mm G=90 mm K=30 mm	C=1,5 mm E=3,0 mm G=90 mm K=30 mm	C=2,0 mm E=6,0 mm G=90 mm K=30 mm	C=3,0 mm E= 6,0 mm G=90 mm K=30 mm
20	4,0	3530-110720- LLLL	3530-111020- LLLL	-	-	-	-
25	4,2	3530-110725- LLLL	3530-111025- LLLL	-	-	-	-
28	4,8	3530-110728- LLLL	3530-111028- LLLL	-	-	-	-
32	5,0	3530-110732- LLLL	3530-111032- LLLL	3530-121232- LLLL	3530-131532- LLLL	-	-
40	5,4	3530-110740- LLLL	3530-111040- LLLL	3530-121240- LLLL	3530-131540- LLLL	3530-162040- LLLL	3530-163040- LLLL
50	6,0	3530-110750- LLLL	3530-111050- LLLL	3530-121250- LLLL	3530-131550- LLLL	3530-162050- LLLL	3530-163050- LLLL
60	6,5	-	-	3530-121260- LLLL	3530-131560- LLLL	3530-162060- LLLL	3530-163060- LLLL
70	6,8	-	-	-	3530-131570- LLLL	3530-162070- LLLL	3530-163070- LLLL
80	7,0	-	-	-	-	3530-162080- LLLL	3530-163080- LLLL
100	7,5	-	-	-	-	3530-162010-LLLL	3530-163010-LLLL