

CAMES À ROULEAUX KLIMA-FLEX 1



Cames à rouleaux pour Klima-flex 1. Les cames à rouleaux réduisent la friction opérationnelle et augmentent la compression du joint.



MATÉRIAU

Roller cam: Zinc die cast, zinc plated, steel, zinc plated and glass fibre reinforced Polyamide (PA6GF30), black

RELATED PRODUCTS

Latching units: 2-311ab, 2-311cd, 2-311ef
Use the Index Code at industrilas.com

TESTS & STANDARDS

Inside handle is only approved in combination with non-locking outside handle.

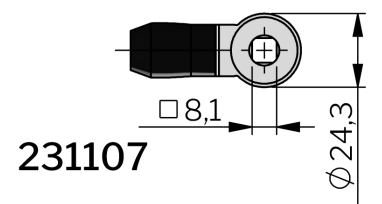
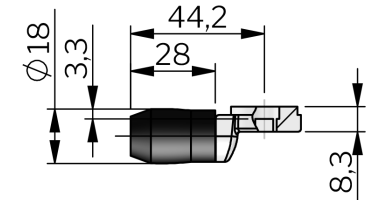
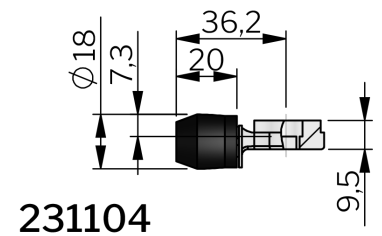
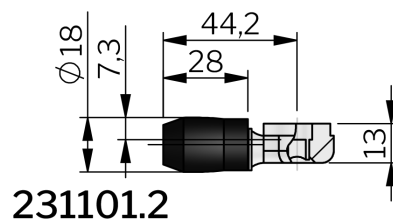
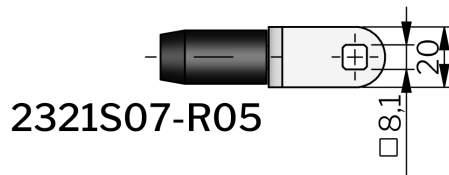
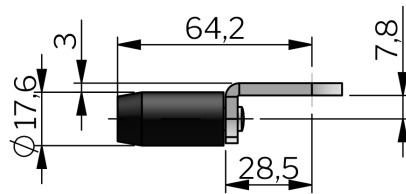
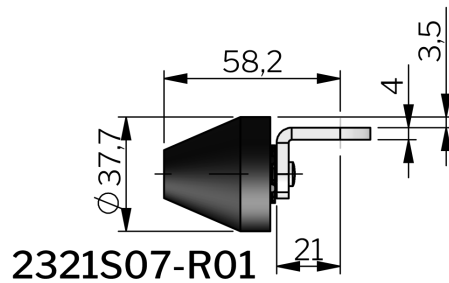

P/N	Description	For locking unit
231101.1	Roller cam	-G50, -GC50
231101.2	Roller cam	All
231104	Roller cam, short version	All
231107	Roller cam	All
2321S07-R01	Roller cam - roller diameter 37,7 mm	All
2321S07-R05	Roller cam - roller diameter 17,6 mm	All