

# KLIMA-FLEX 1-RULLREGLAR



Rullreglar för Klima-flex 1. Rullreglarna minskar friktionen under manövrering och ökar tätningskompressionen.



## MATERIAL

**Roller cam:** Zinc die cast, zinc plated, steel, zinc plated and glass fibre reinforced Polyamide (PA6GF30), black

## RELATERADE PRODUKTER

**Latching units:** 2-311ab, 2-311cd, 2-311ef  
Use the Index Code at [industrilas.com](http://industrilas.com)

## TESTS & STANDARDS

Inside handle is only approved in combination with non-locking outside handle.

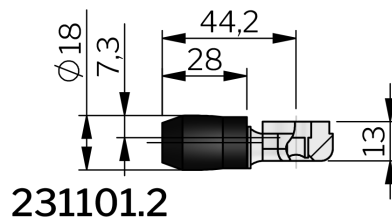
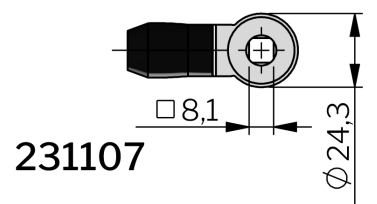
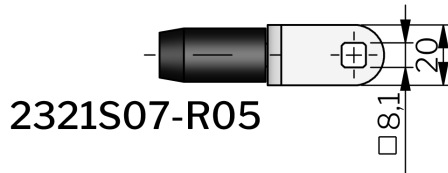
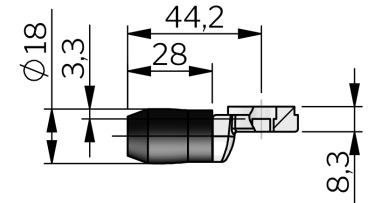
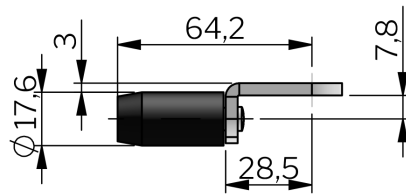
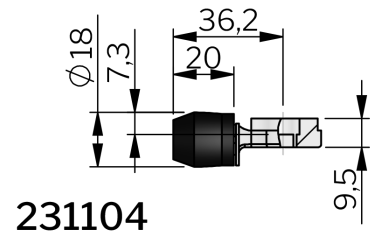
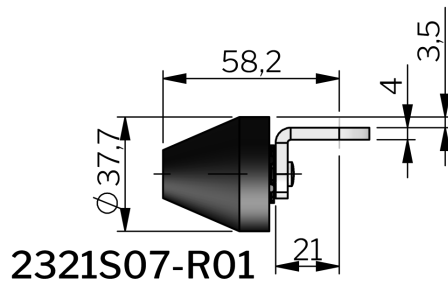

Artikelnummer	Beskrivning	För låsenhet
231101.1	Roller cam	-G50, -GC50
231101.2	Roller cam	All
231104	Roller cam, short version	All
231107	Roller cam	All
2321S07-R01	Roller cam - roller diameter 37,7 mm	All
2321S07-R05	Roller cam - roller diameter 17,6 mm	All